



Sterlization, Asepsis
Sterlization, Asepsis
Esterilization, Asepsia
Sterilisation, Asepsis
Sterilizzazione, Asepsi

Tel# 0092-52-4260785
Fax# 0092-52-4266804
Email. Info@benison.com.pk

Needle Cases



PR.15.05 = 50 x 25 x 4,5 mm
PR.15.08 = 65 x 42 x 8 mm
PR.15.06 = 75 x 25 x 4,5 mm



PR.16.05 = 50 x 25 x 4,5 mm
PR.16.08 = 65 x 42 x 8 mm
PR.16.06 = 75 x 25 x 4,5 mm



Trays



PAF.05.63
 235 x 190 x 40 mm

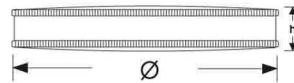

complete	insert only
PR.19.65 Ø = 65 mm h = 15 mm	PR.19.70 Ø = 62 mm h = 13 mm



PAF.05.82
 Ø 200 x 70 mm

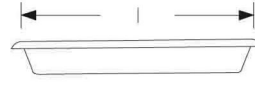
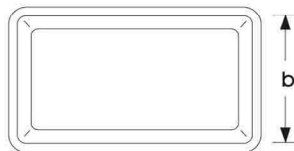

	l	b	h
PAF.04.20	200	150	38
PAF.04.25	250	200	50
PAF.04.30	300	250	50
PAF.04.35	355	305	50
PAF.04.40	405	305	50



PAF.04.20- PAF.04.40

Forceps Jars



Size in mm Ø X h	Jar without lid	Jar with lid
30 x 90	PAF.15.30	PAF.15.54
50 x 100	PAF.15.50	PAF.15.55
50 x 130	PAF.15.51	PAF.15.56
50 x 175	PAF.15.52	PAF.15.57
75 x 100	PAF.15.75	PAF.15.80
75 x 130	PAF.15.76	PAF.15.81
75 x 175	PAF.15.77	PAF.15.82
100 x 175	PAF.15.98	PAF.15.88
100 x 200	PAF.15.99	PAF.15.89

Instrument Box



PAF.20.20
205 x 105 x 40 mm

Kidney Trays



Size in mm l x b x h		
170 x 100 x 35	PAF.10.17	17 cm/ 6 3/4"
250 x 140 x 40	PAF.10.25	25 cm/ 10"
275 x 150 x 45	PAF.10.27	27 cm/ 10 3/4"

Instrument Boxes



Size in mm

L x w x h

165 x 85 x 35	PAF.21.46
200 x 100 x 35	PAF.21.50
200 x 100 x 50	PAF.21.51
230 x 130 x 50	PAF.21.53
260 x 150 x 50	PAF.21.56

270 x 235 x 50	PAF.21.57
300 x 200 x 50	PAF.21.60
325 x 275 x 30	PAF.21.62
325 x 275 x 50	PAF.21.63
420 x 80 x 40	PAF.21.72

420 x 175 x 50	PAF.21.75
----------------	------------------

Cotton Dispensers



Methot
PAF.35.01 **PAF.35.02**
 ø50 x 75 mm
 With lid Without lid



Spirit Lamp
19-1505
 120 cc

Cotton wool containers



Size in mm Lid with knob
 ø X h

75 x 60	PAF.08.07
75 x 75	PAF.08.08
100 x 60	PAF.08.10
100 x 100	PAF.08.11
125 x 80	PAF.08.12
125 x 125	PAF.08.13
150 x 100	PAF.08.14
150 x 150	PAF.08.15
200 x 100	PAF.08.20
200 x 150	PAF.08.21
200 x 200	PAF.08.22
240 x 160	PAF.08.24
240 x 230	PAF.08.25
290 x 160	PAF.08.29
290 x 240	PAF.08.30

Sterilization Drums



Schimmelbusch
(Horizontal Ventilation)

Ø	h	
140 x 140 mm		PR.25.14
160 x 150 mm		PR.25.16
190 x 160 mm		PR.25.19
190 x 190 mm		PR.25.20
240 x 120 mm		PR.25.24
240 x 160 mm		PR.25.25
240 x 240 mm		PR.25.27
290 x 160 mm		PR.25.29
290 x 240 mm		PR.25.30
340 x 160 mm		PR.25.34
340 x 240 mm		PR.25.35
390 x 140 mm		PR.25.39
390 x 190 mm		PR.25.40
390 x 290 mm		PR.25.41



Konrich
(Vertical Ventilation)

Ø	h	
140 x 140 mm		PR.26.14
160 x 150 mm		PR.26.16
190 x 160 mm		PR.26.19
190 x 190 mm		PR.26.20
240 x 120 mm		PR.26.24
240 x 160 mm		PR.26.25
240 x 240 mm		PR.26.27
290 x 160 mm		PR.26.29
290 x 240 mm		PR.26.30
340 x 160 mm		PR.26.34
340 x 240 mm		PR.26.35
390 x 140 mm		PR.26.39
390 x 190 mm		PR.26.40
390 x 290 mm		PR.26.41

Norm Trays

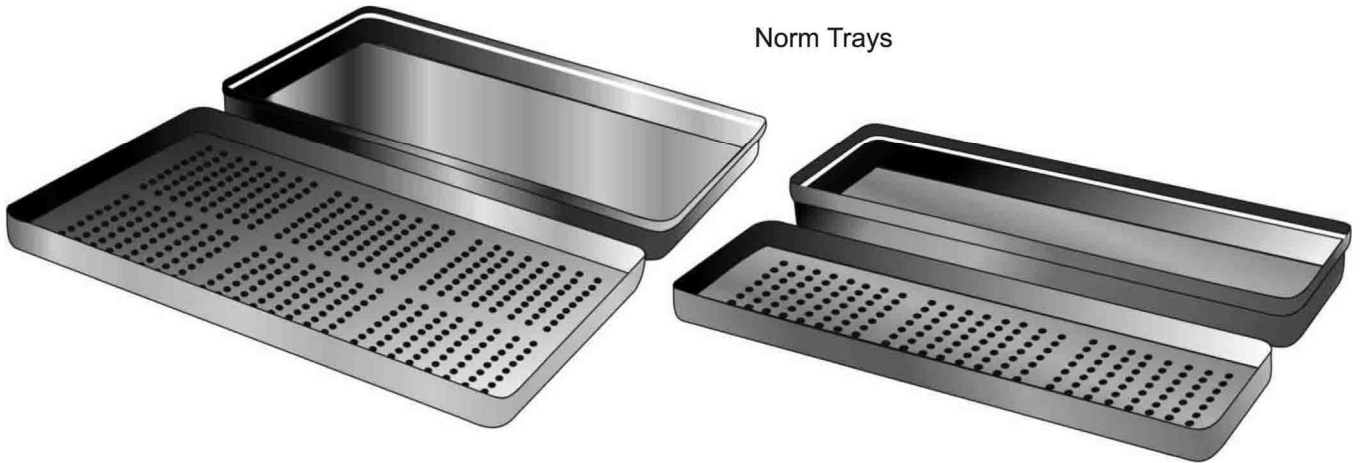

19-2101 - 19-2104
 288 x 187 x 40 mm

19-2201 - 19-2204
 288 x 93 x 40 mm

	Tablet	Lid	
19-2101	Perforated	Unperforated	19-2201
19-2102	Unperforated	Unperforated	19-2202
19-2103	Perforated	Perforated	19-2203
19-2104	Unperforated	Perforated	19-2204

Inserts for Trays

